

# Program of Study Block

## New programs

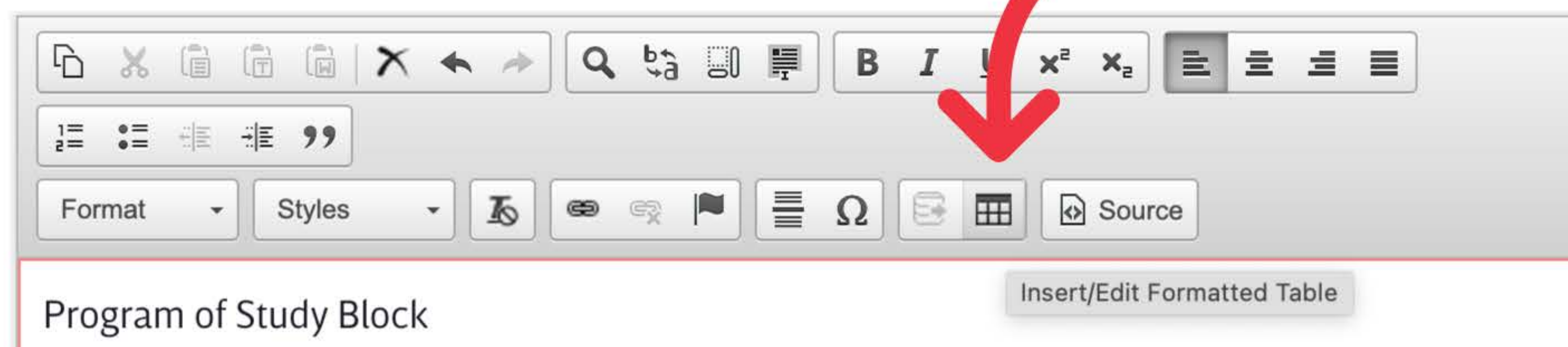

If you are creating a new program, you will need to select the 'Insert/Edit a Formatted Table' icon from the toolbar.

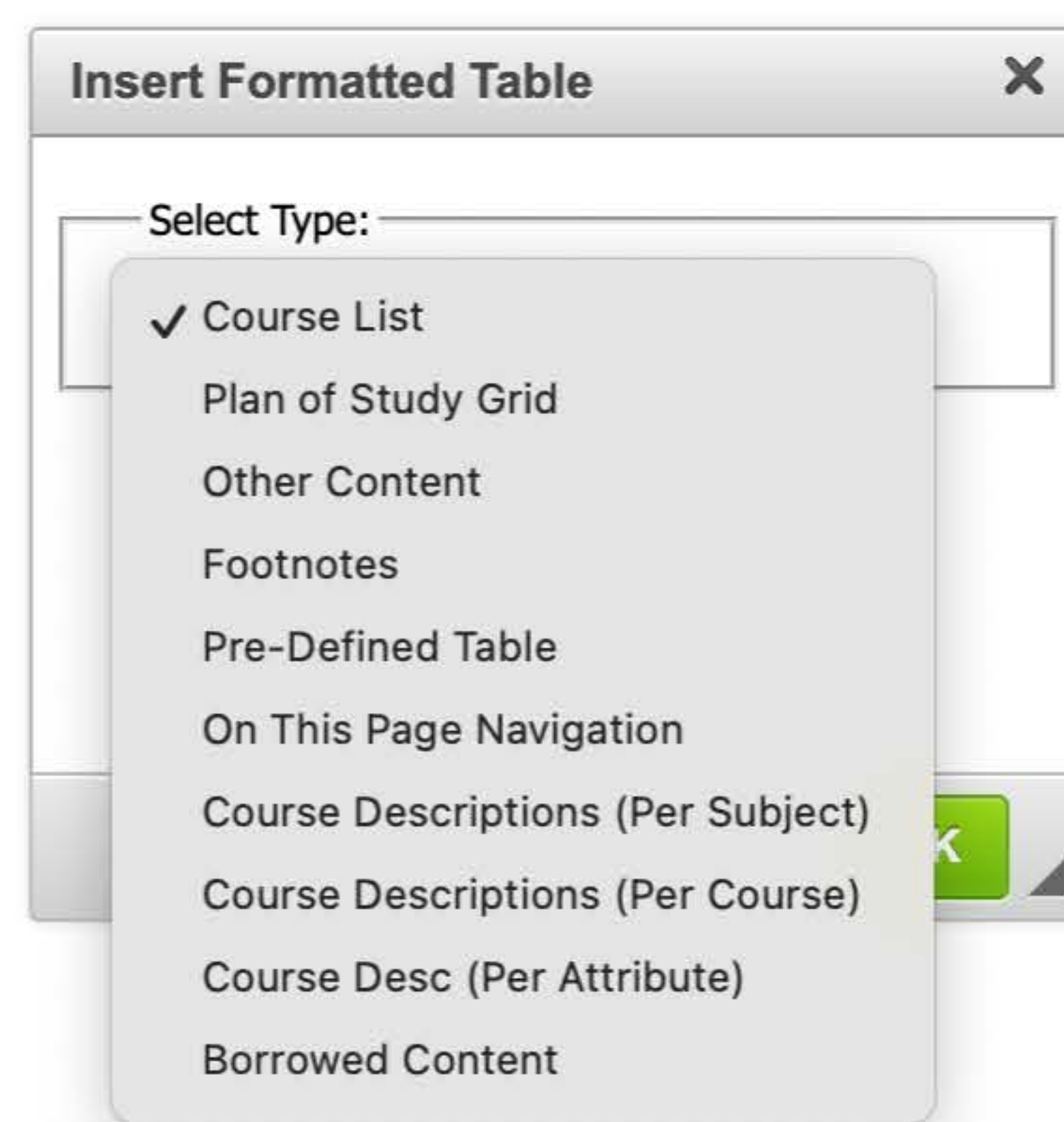

You will select Course List from the dropdown menu of choices.

## Existing programs

### Master of Arts in Emergent Digital Practices

#### Degree Requirements

#### Coursework Requirements



Course List	
<b>Graduate Foundations</b>	<b>12</b>
<a href="#">EDPX 4000</a>	Digital Design Concepts
<a href="#">EDPX 4010</a>	Emergent Digital Tools
<a href="#">EDPX 4020</a>	Emergent Digital Cultures
<b>EDP Electives</b>	<b>24</b>
Select at least 1 EDP Studio and at least 1 EDP Cultures	
Courses meeting Studio/Making requirement:	

If you wish to edit the program of study block for an existing program, you simply need to double-click anywhere on or within the blue border.

# Adding Courses

Course List

Business Information&Analytics (INFO)

INFO 4381 Decision Processes

Sum Hours

Comment:

Sequence:

Cross Reference:

Or Class:

Hours: 2

Footnote:

Indent  Area Header

Move Up Move Down

Cancel OK

## Adding Courses via the course inventory

The Course List tool allows users to select courses from an inventory arranged by college and subject code. The double arrows will move the course into the program of study block. The double arrows can also be used to move unwanted courses or comments out of the program of study block.

Course List

Business Information&Analytics (INFO)

INFO 4590 Optimization

Quick Add: INFO 4590

Sum Hours

INFO 4381 Decision Processes

Comment:

Sequence:

Cross Reference:

Or Class:

Hours: 2

Footnote:

Indent  Area Header

Move Up Move Down

Cancel OK

## Adding Courses via Quick Add

Alternately, users can add courses by entering a valid subject code and course number in the 'Quick Add' area of the form.

Course List

Business Information&Analytics (INFO)

INFO 4340 Data Mining and Visualization

Quick Add:

Sum Hours

**This Will Be an Area Header**

INFO 4381 Decision Processes

INFO 4590 Optimization

**This is a list of indented courses which will not count in the total**

INFO 4240 Data Warehousing

INFO 4260 Data Management Platforms

INFO 4300 Predictive Analytics

Comment:

Sequence:

Cross Reference:

Or Class:

Hours: 4

Footnote:

Indent  Area Header

Move Up Move Down

Cancel OK

## Indented Courses

When the 'Indent' check box is checked, the course will not total in the 'Sum Hours' function for the course list. The indent checkbox should only be used when students are being given a list of electives from which to choose.

# Course Entry Features

**Course List**

Natural Sciences & Mathematics  
Biology (BIOL)

Sum Hours

BIOL -4 Advanced topics in Anatomy and Physiology  
BIOL 1005 Perspectives-Veterinary Medicine  
BIOL 1010 Physiological Systems  
BIOL 1011 Evolution, Heredity and Biodiversity  
BIOL 1020 Physiological Systems Lab  
BIOL 1021 Evolution, Heredity and Biodiversity Lab  
BIOL 1207 Ecology for the New Millennium I  
BIOL 1208 Ecology for the New Millennium II  
BIOL 1209 Ecology for the New Millennium III  
BIOL 1221 Molecules to Humankind II  
BIOL 1222 Molecules to Humankind III  
BIOL 1230 Origin & Evolution of Life I  
BIOL 1231 Origin & Evolution of Life II  
BIOL 1232 Origin & Evolution of Life III  
BIOL 1260 Sustaining Life I  
BIOL 1261 Sustaining Life II

Quick Add:

**This Will Be an Area Header**  
INFO 4381 Decision Processes  
INFO 4590 Optimization  
The following course series is required:  
BIOL 1220 Molecules to Humankind I

Comment:

Sequence:

Cross Reference:

Or Class:

Hours:

Footnote:

Indent  Area Header

**Course List**

Natural Sciences & Mathematics  
Mathematics (MATH)

Sum Hours

MATH 1941 Calculus I Workshop  
MATH 1942 Calculus II Workshop  
MATH 1943 Calculus III Workshop  
MATH 1951 Calculus I  
MATH 1952 Calculus II  
MATH 1953 Calculus III  
MATH 1962 Honors Calculus II  
MATH 1963 Honors Calculus III  
MATH 1988 Study Abroad Resident Credit  
MATH 1XXX Math Transfer  
MATH 2060 Elements of Linear Algebra  
MATH 2070 Introduction to Differential Equations  
MATH 2080 Calculus of Several Variables  
MATH 2200 Mathematical Reasoning & Proof  
MATH 2988 Study Abroad Resident Credit  
MATH 2XXX Math Transfer  
MATH 3000 The Real World Seminar

Quick Add:

**This Will Be an Area Header**  
INFO 4381 Decision Processes  
INFO 4590 Optimization  
The following course series is required:  
BIOL 1220 Molecules to Humankind I  
MATH 2050 Symbolic Logic

Comment:

Sequence:

Cross Reference:

Or Class:

Hours:

Footnote:

Indent  Area Header

**Course List**

Undergraduate General  
Writing (WRIT)

Sum Hours

WRIT 1022 English for Academic Purposes  
WRIT 1133 Writing and Research  
WRIT 1533 Writing and Research  
WRIT 1622 Advanced Rhetoric and Writing  
WRIT 1633 Advanced Writing and Research  
WRIT 1733 Honors Writing  
WRIT 1991 Independent Study  
WRIT 1XXX Writing Transfer  
WRIT 2000 Theories of Writing  
WRIT 2040 Memoir and Personal Writing  
WRIT 2050 Style and Rhetorical Grammar  
WRIT 2100 Internship in Writing and Rhetoric  
WRIT 2120 Writing for Wellness  
WRIT 2200 Environmental Writing  
WRIT 2300 Professional Writing  
WRIT 2400 Editing and Publishing  
WRIT 2500 Topics in Writing Theory, History

Quick Add:

**This Will Be an Area Header**  
INFO 4381 Decision Processes  
INFO 4590 Optimization  
The following course series is required:  
BIOL 1220 Molecules to Humankind I  
MATH 2050 Symbolic Logic  
WRIT 1122 Rhetoric and Academic Writing

Comment:

Sequence:

Cross Reference:

Or Class:

Hours:

Footnote:

Indent  Area Header

## Course Sequences

Courses that are required to be taken as a sequence or series may be entered in the sequence field. Note: both subject code and course number must be entered. The hours will need to be manually update to appear correctly. In this example, the 4 in the hours field was manually updated to 12.

The following course series is required:

[BIOL 1220](#) Molecules to Humankind I 12  
& [BIOL 1221](#) and Molecules to Humankind II  
& [BIOL 1222](#) and Molecules to Humankind III

## Course Cross List

Cross list courses maybe entered in the cross reference field. Note: both subject code and course number must be entered.

[MATH](#) Symbolic Logic 4  
[2050/PHIL 2160](#)

## Or Courses

When students have a choice in meeting a requirement by taking one of two courses, this may be entered as an 'or course. Note: both subject code and course number must be entered.

[WRIT 1122](#) Rhetoric and Academic Writing 4  
or [WRIT 1622](#) Advanced Rhetoric and Writing

# Comment Entry and Editing

Course List ✕

Sum Hours

WRIT 1022 English for Academic Purposes	<b>This Will Be an Area Header</b>
WRIT 1133 Writing and Research	INFO 4381 Decision Processes
WRIT 1533 Writing and Research	INFO 4590 Optimization
WRIT 1622 Advanced Rhetoric and Writing	The following course series is required:
WRIT 1633 Advanced Writing and Research	BIOL 1220 Molecules to Humankind I
WRIT 1733 Honors Writing	MATH 2050 Symbolic Logic
WRIT 1991 Independent Study	WRIT 1122 Rhetoric and Academic Writing
WRIT 1XXX Writing Transfer	
WRIT 2000 Theories of Writing	
WRIT 2040 Memoir and Personal Writing	
WRIT 2050 Style and Rhetorical Grammar	
WRIT 2100 Internship in Writing and Rhetoric	
WRIT 2120 Writing for Wellness	
WRIT 2200 Environmental Writing	
WRIT 2300 Professional Writing	
WRIT 2400 Editing and Publishing	
WRIT 2500 Topics in Writing Theory, History, and Practice	

Quick Add:

Enter comment text:

Reference:

Or Class:

Hours:

Footnote:

Indent  Area Header

## Comment Entry

Any information other course must be entered as a comment. Users will click the 'Add Comment Entry' button to launch a window that will allow comment entry into the program of study block.

Course List ✕

Undergraduate General

Writing (WRIT)

Sum Hours

WRIT 1022 English for Academic Purposes	<b>This Will Be an Area Header</b>
WRIT 1133 Writing and Research	INFO 4381 Decision Processes
WRIT 1533 Writing and Research	INFO 4590 Optimization
WRIT 1622 Advanced Rhetoric and Writing	The following course series is required:
WRIT 1633 Advanced Writing and Research	BIOL 1220 Molecules to Humankind I
WRIT 1733 Honors Writing	MATH 2050 Symbolic Logic
WRIT 1991 Independent Study	WRIT 1122 Rhetoric and Academic Writing
WRIT 1XXX Writing Transfer	
WRIT 2000 Theories of Writing	
WRIT 2040 Memoir and Personal Writing	
WRIT 2050 Style and Rhetorical Grammar	
WRIT 2100 Internship in Writing and Rhetoric	
WRIT 2120 Writing for Wellness	
WRIT 2200 Environmental Writing	
WRIT 2300 Professional Writing	
WRIT 2400 Editing and Publishing	
WRIT 2500 Topics in Writing Theory, History, and Practice	

Quick Add:

Comment:

Sequence:

Cross Reference:

Or Class:

Hours:

Footnote:

Indent  Area Header

## Comment Editing

Comments are edited in the comment field.

Course List ✕

Undergraduate General

Writing (WRIT)

Sum Hours

WRIT 1022 English for Academic Purposes	<b>This Will Be an Area Header</b>
WRIT 1133 Writing and Research	INFO 4381 Decision Processes
WRIT 1533 Writing and Research	INFO 4590 Optimization
WRIT 1622 Advanced Rhetoric and Writing	<b>The following course series is required:</b>
WRIT 1633 Advanced Writing and Research	BIOL 1220 Molecules to Humankind I
WRIT 1733 Honors Writing	MATH 2050 Symbolic Logic
WRIT 1991 Independent Study	WRIT 1122 Rhetoric and Academic Writing
WRIT 1XXX Writing Transfer	
WRIT 2000 Theories of Writing	
WRIT 2040 Memoir and Personal Writing	
WRIT 2050 Style and Rhetorical Grammar	
WRIT 2100 Internship in Writing and Rhetoric	
WRIT 2120 Writing for Wellness	
WRIT 2200 Environmental Writing	
WRIT 2300 Professional Writing	
WRIT 2400 Editing and Publishing	
WRIT 2500 Topics in Writing Theory, History, and Practice	

Quick Add:

Comment:

Sequence:

Cross Reference:

Or Class:

Hours:

Footnote:

Indent  Area Header

## Area Headers and Comments

The 'Area Header' checkbox will make the comment appear in a bold font.

# Footnote Entry

Course List

Undergraduate General  
Writing (WRIT)

Sum Hours

**This Will Be an Area Header**

INFO 4381 Decision Processes  
**INFO 4590 Optimization**

The following course series is required:

BIOL 1220 Molecules to Humankind I  
MATH 2050 Symbolic Logic  
WRIT 1122 Rhetoric and Academic Writing

Comment:   
Sequence:   
Cross Reference:   
Or Class:   
Hours:   
Footnote:

Indent  Area Header

Move Up Move Down

Quick Add:  Add Course

Add Comment Entry

Cancel OK

## Target Course

Select the course that is the target for your footnote and then enter the footnote number or symbol in the footnote field.

or WRIT 1622 Advanced Rhetoric and Writing

Total Credits	26
---------------	----

Insert paragraph here

## Creating the Footnote

You will probably need to create a space below the program requirements block for your footnote. To do this place your cursor below the blue outline until a red arrow and dotted line appear. Click on the arrow or line to create more space.

Go back to the toolbar and click on the Insert/Edit Formatted Table icon.

Program of Study Block

Insert/Edit Formatted Table

The following course series is required:

BIOL 1220 & BIOL 1221 & BIOL 1222	M	12
MATH 2050/PHIL 2160	S	4
WRIT 1122 or WRIT 1622	F	4
Total Credits		26

Insert Formatted Table

Select Type:

- Course List
- Plan of Study Grid
- Other Content
- Footnotes**
- Pre-Defined Table
- On This Page Navigation
- Course Descriptions (Per Subject)
- Course Descriptions (Per Course)
- Course Desc (Per Attribute)
- Borrowed Content

You will select Footnotes from the dropdown menu of choices.

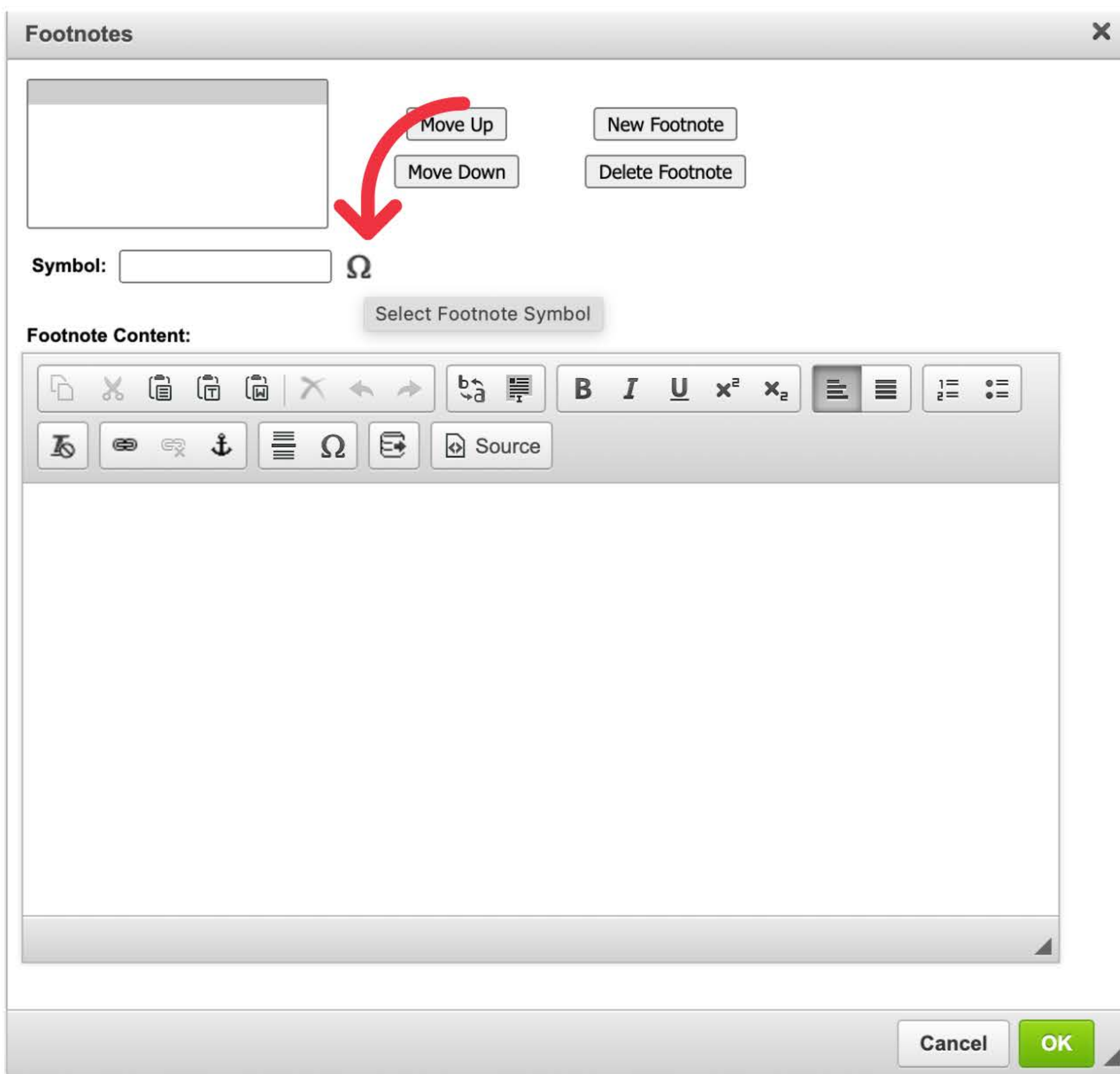

You can either click the symbol icon (the Greek letter omega) to bring up an interface that will allow you to select numbers or common symbols in the footnote area. You can also simply type a number or symbol in the field labeled 'Symbol'. Obviously, the footnote entered here should match the number or symbol for the course in the program of study block.

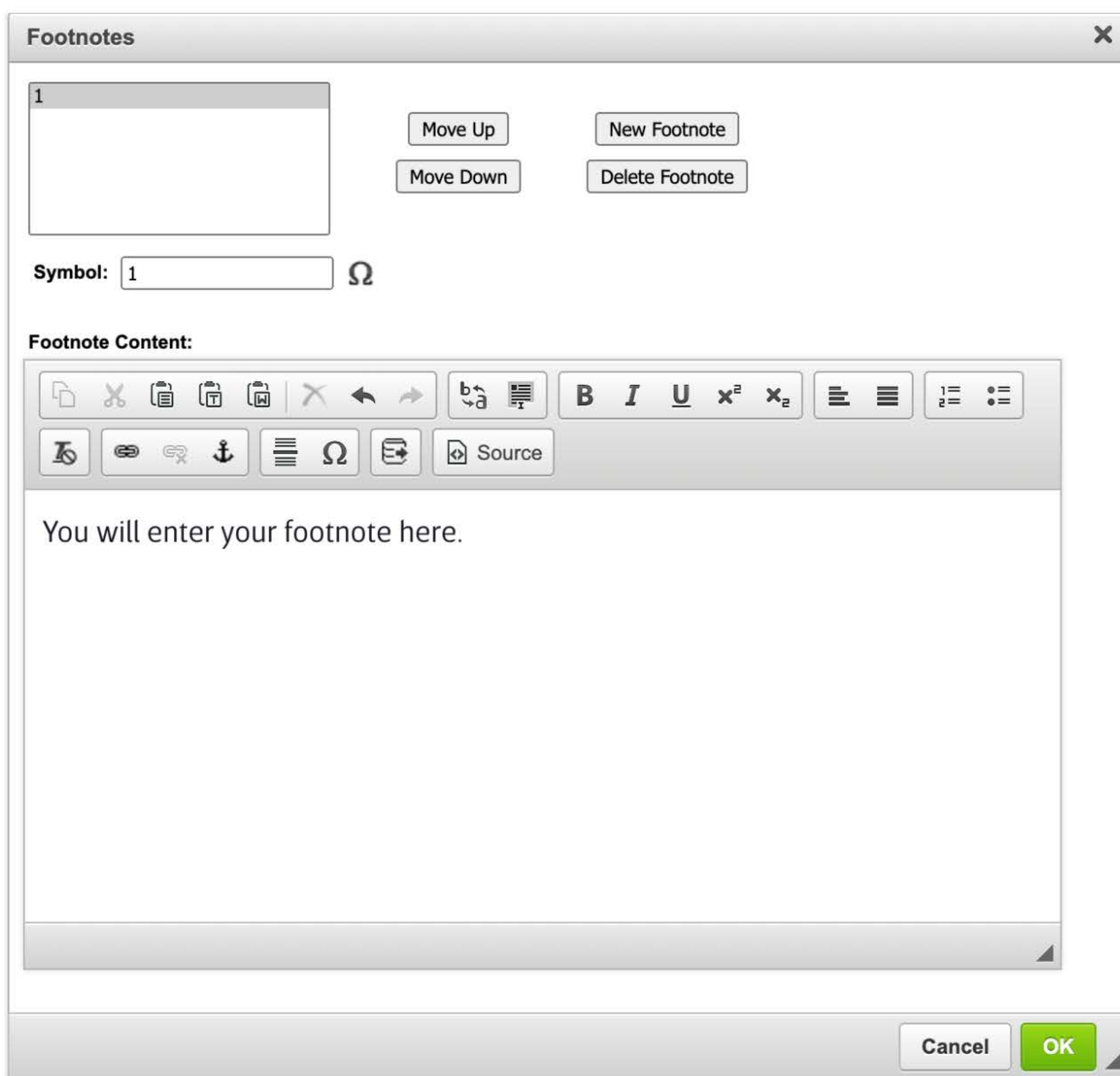

Once you have created the footnote number or symbol, you can enter content for that footnote.

& <a href="#">BIOL 1222</a>	and Molecules to Humankind III	
<a href="#">MATH 2050/PHIL 2160</a>	Symbolic Logic	4
<a href="#">WRIT 1122</a>	Rhetoric and Academic Writing	4
or <a href="#">WRIT 1622</a>	Advanced Rhetoric and Writing	
<b>Total Credits</b>		<b>26</b>

Your footnote will look similar to this example.



## Additional Notes

Sum Hours



The 'Sum Hours' box should always be checked and the field should be left blank.

Hours:

Do not enter numbers in the hours field unless you are correcting an error in credits for a sequence of courses or entering a fixed number of credits for a variable credit course.